

PASS 2.40R THROUGH INTERSECTION OF CONSTRUCTION LINES 'A' AND 3.85 ± .15 AS SHOWN.

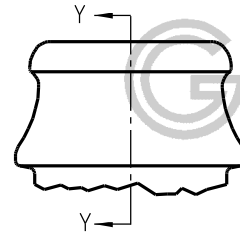
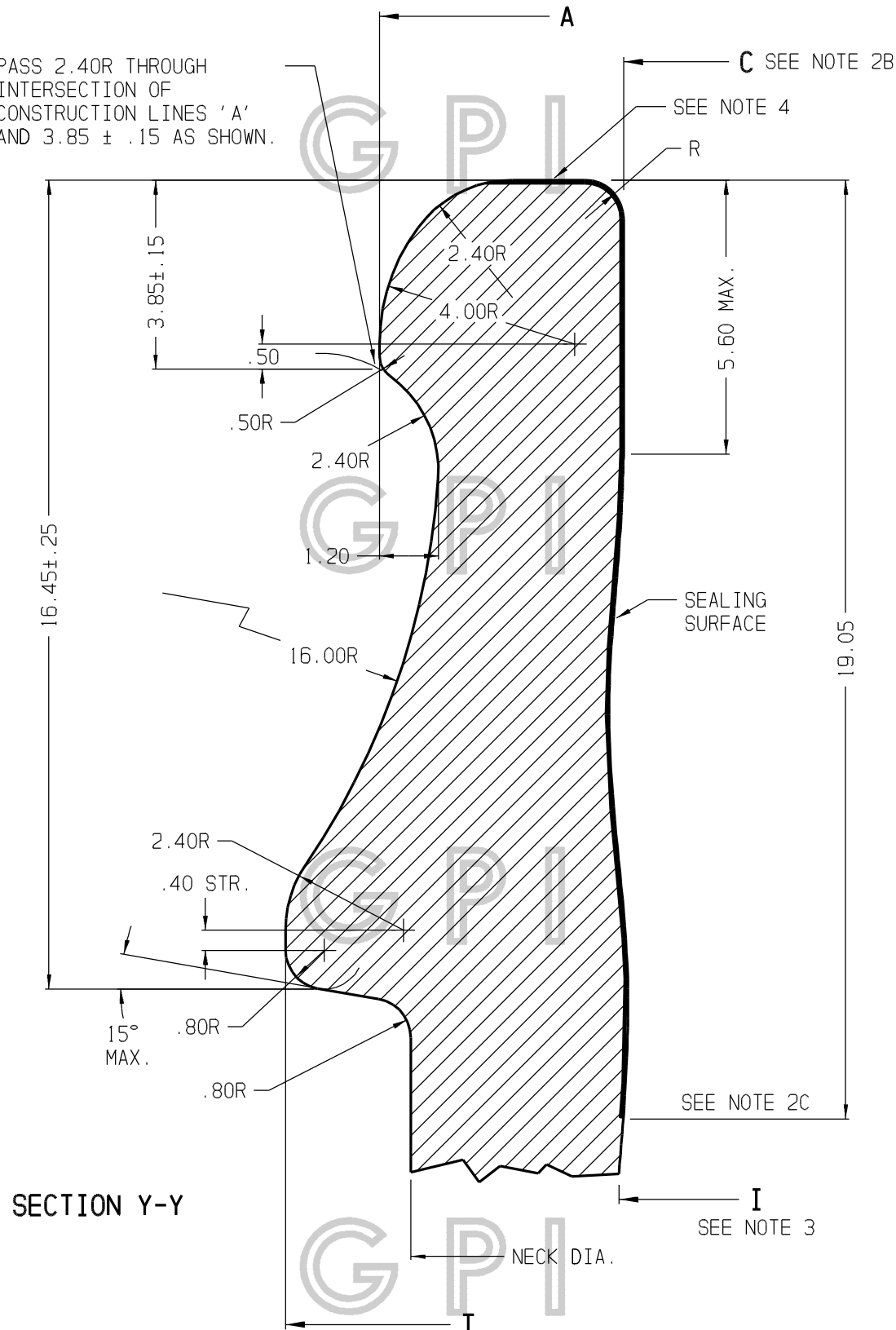

| SIZE | NECK DIA. | A | T | I MIN. | C MAX. |
|--------|-----------|-------------|-------------|--------|--------|
| 26-32 | 25.40 | 26.65 ± .35 | 30.50 ± .35 | 16.35 | 17.05 |
| 26-32A | 27.00 | 26.65 ± .35 | 32.15 ± .35 | 16.35 | 17.05 |
| 26-32B | 28.60 | 26.65 ± .35 | 33.20 ± .35 | 16.35 | 17.05 |
| 26-32C | 30.20 | 26.65 ± .35 | 35.35 ± .35 | 16.35 | 17.05 |

1. USERS ARE RESPONSIBLE FOR CHOICE AND APPLICATION OF NATURAL CORKS USED. NATURAL CORK DIAMETER AND DESIGN MUST BE QUALIFIED BY THE USER FOR DESIRED FIT AND FUNCTION THROUGH PERFORMANCE TESTING FOR EACH NATURAL CORK SUPPLIER USED.
2. A. THE INNER LIP CONTOUR IS SUBJECT TO NORMAL MANUFACTURING VARIATIONS.
B. 'C' DIMENSION CONTROLS OPENING TO 5.60 DOWN FROM TOP OF FINISH EXCLUDING RADIUS.
C. THE OPENING BELOW THIS 5.60 DISTANCE TO A POINT 19.05 BELOW THE TOP OF THE FINISH SHOULD BE NO LESS THAN 16.35 AND NO GREATER THAN 18.55.
D. IT IS DESIRABLE FOR GOOD CORK FIT TO CONTROL OPENING BELOW 5.60 TO BE SLIGHTLY GREATER THAN SMALLEST OPENING ABOVE.
3. 'I' DIMENSION OR THROAT OPENING IS MEASURED THROUGH FULL LENGTH OF GLASS FINISH AND NECK.
4. CROWN CLOSURE SEALING SURFACE WHEN CROWNS ARE USED.

SECTION Y-Y

THIS OFFICIAL GLASS PACKAGING INSTITUTE PRINT CONSTITUTES ONE IN A SERIES OF VOLUNTARY STANDARDS INTENDED TO PROVIDE A BASIS FOR ACHIEVING COMPATIBILITY AND INTERCHANGEABILITY BETWEEN MANUFACTURERS AND USERS OF GLASS CONTAINERS AND CLOSURES THEREFOR. THE USER SHOULD BE AWARE THAT OTHER CONTAINER AND CLOSURE DESIGNS MAY DIFFER FROM THIS VOLUNTARY STANDARD, AND IT IS THE USER'S RESPONSIBILITY TO MAKE THE FINAL DETERMINATION AS TO DESIGN AND COMPATIBILITY. GPI ASSUMES NO RESPONSIBILITY FOR EITHER THE USE OF OR INTERPRETATION OF THE STANDARD, FOR IT BEING CURRENT, OR FOR THE DETERMINATION WHETHER ANY PARTICULAR MANUFACTURER'S PRODUCT CONFORMS TO THE STANDARD. THIS DRAWING CONTAINS INFORMATION TAKEN FROM ONE OR MORE PRINTS OF THE GLASS PACKAGING INSTITUTE (GPI). GPI OWNS ALL RIGHT, TITLE AND INTEREST IN THE COPYRIGHTS TO THIS DRAWING AND TO THESE PRINTS. GPI REQUIRES THAT YOU NOT REPRODUCE THIS DRAWING FOR OR DISTRIBUTE THIS DRAWING TO ANY THIRD PARTY WITHOUT GPI'S WRITTEN CONSENT. ANY INQUIRIES OR SUGGESTIONS CONCERNING THIS STANDARD CAN BE ADDRESSED TO THE GLASS PACKAGING INSTITUTE, WASHINGTON D.C. AT WWW.GPI.ORG.

| | | | |
|--|--|---|---------------------------------|
| PRINTED AND DISTRIBUTED AS A VOLUNTARY STANDARD BY GLASS PACKAGING INSTITUTE COMMITTEE ON DESIGN AND SPECIFICATIONS | | APPROVED FOR PUBLICATION 01-15-99 | SUPERSEDES DWG. NO. FM-31503 |
| Edward A. Grant CHAIRMAN | | GPI DWG. NO. FM-31504 | |
| GLASS FINISH NUMBER 3150M | | METRIC COMBINATION NATURAL CORK AND CROWN CHAMPAGNE FINISH FM-31504 | |